

A3 Colour Intelligent Devices

RICOH
IM C3000(A)
IM C3500(A)

✔ Printer ✔ Copier ✔ Scanner ✔ Fax



Welcome to a new era of technology that keeps your workplace up-to-date, now and in the future. Smarter working made simple thanks to the IM C3000(A)/C3500(A).

Now is the time to:

- Protect your devices with easy access to security updates
- Take advantage of easy productivity upgrades at your own pace
- Save costs by bringing high-standard quality print output in-house
- Maximise productivity with streamlined workflows

Today's workplace needs to be ready for tomorrow. Ricoh's intelligent devices provide smooth access to functionality upgrades and productivity enhancements when they are released, without needing to change your hardware. Turn your device into a powerful hub that helps you manage information workflows efficiently, using technology that's scalable, secure, sustainable and simple.

Get greater control of scan and print management:

- Scan smaller documents with the small size paper scan unit
- Improve scan accuracy – double feed detection unit
- Enhance print management – with EFI controller
- Produce professional grade flyers with inner multi-folding unit

Embrace lower running costs and reduced energy consumption thanks to environmentally friendly low TEC (Typical Electricity Consumption) values. Furthermore, take advantage of RICOH Intelligent Support services that anticipate potential issues and send corrective instructions via the Smart Operation Panel, avoiding interruptions and prolonging the optimal performance of your device – avoiding the need for intervention by more costly IT resources.

Printing from 30 to 35 CPM, the IM C3000(A)/C3500(A) offer next-level productivity. Interact with the 10.1" Smart Operation Panel like a typical smart device and configure it for quick and easy access to apps you use most often. A variety of mobile connectivity options enable printing or scanning to the office network or cloud from a smart device, with built-in support for NFC, AirPrint* or Mopria. All this underpinned by a unique suite of support apps from RICOH Smart Integration.

Our intelligent devices offer:

- Efficient working and reduced user intervention – by expanding paper capacity
- Variable finishing and paper options – for a professional touch
- A consistent user experience across your fleet
- Maximum device uptime and minimal disruption with RICOH Intelligent Support

IM C3000(A) / IM C3500(A) hardware configuration

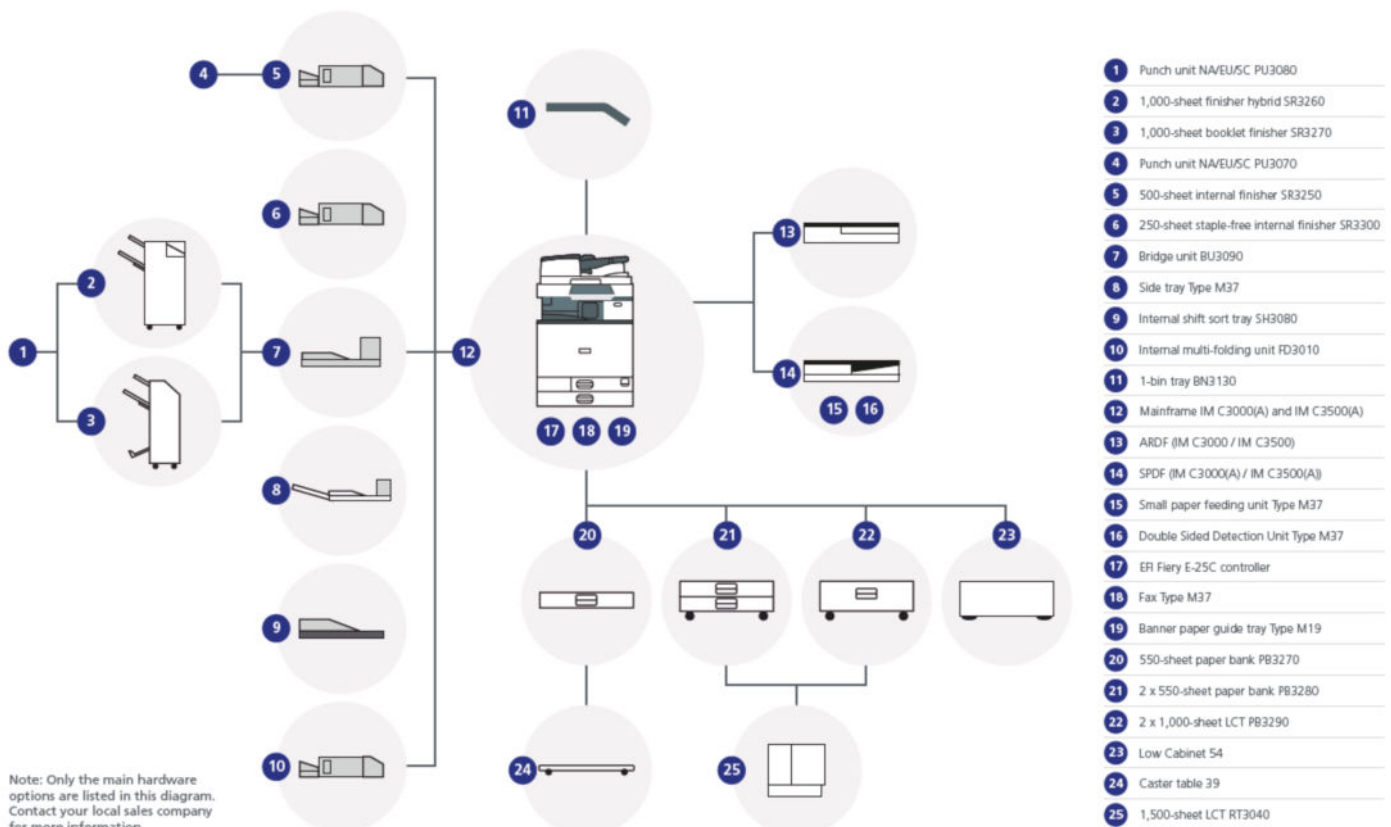

RICOH IM C3000A/IM C3000/IM C3500A/IM C3500

MAIN SPECIFICATIONS

	IM C3000A	IM C3000	IM C3500A	IM C3500
GENERAL				
Warm-up time			21 seconds	
First copy speed: B/W			4.5 seconds	
First copy speed: full colour			6.9 seconds	
Continuous output speed	30 ppm	30 ppm	35 ppm	35 ppm
Memory: standard			2 GB	
Memory: maximum			4 GB	
HDD: standard			320 GB	
HDD: maximum			320 GB	
ARDF capacity			sheets	
SPDF capacity			sheets	
Weight	99.4 kg	94 kg	99.4 kg	94 kg
Dimensions: W x D x H	587 x 685 x 963 mm	587 x 685 x 913 mm	587 x 685 x 963 mm	587 x 685 x 913 mm
Power source			220 - 240 V, 50 - 60 Hz	
COPIER				
Multiple copying			Up to 999 copies	
Resolution			600 dpi	
Zoom			From 25% to 400% in 1% steps	
PRINTER				
CPU			ApolloLake E3930 1.3 GHz	
Printer language: standard			PCL5c, PCL6, PostScript 3 (emulation), PDF direct (emulation)	
Printer language: option			Genuine Adobe® PostScript®3™, PictBridge, PDF Direct from Adobe®	
Print resolution: maximum			1,200 x 1,200 dpi	
Network interface: standard			Ethernet 10 base-T/100 base-TX/1000 base-T, USB Host I/F Type A, USB Device I/F Type B	
Network interface: option			Bi-directional IEEE 1284, Wireless LAN (IEEE 802.11a/b/g/n), Additional NIC (2nd port)	
Mobile printing capability			Apple AirPrint, Mopria®, NFC, Ricoh Smart Device Connector	
Windows® environments			Windows® 7, Windows® 8.1, Windows® 10, Windows® Server 2008, Windows® Server 2008R2, Windows® Server 2012R2, Windows® Server 2016, Windows® 7/8.1/10, Windows® Server 2008/2012/2012R2/2016, Windows® Server 2019	
Mac OS environments			Macintosh OS X Native v10.11 or later	
UNIX environments			UNIX Sun® Solaris, HP-UX, SCO OpenServer, RedHat® Linux Enterprise, IBM® AIX	
SAP® environments			SAP® R/3®, SAP® S/4®	
Other supported environments			IBM iSeries	
SCANNER				
Scanning speed: ARDF (A4 LEF, B/W full colour)			80 ipm (200/300 dpi)	
Scanning speed: SPDF (A4 LEF, 200dpi, B/W full colour)			120 ipm (simplex)/240 ipm (duplex)	
Resolution: maximum			1,200 dpi	
Compression method				
File formats			Single Page TIFF, Single page JPEG, Single page High compression PDF, Single page PDF/A, Multi page TIFF, Multi page PDF, Multi page High compression PDF, Multi page PDF/A	
Scan modes			E-mail, Folder, USB, SD Card	
FAX				
Circuit			PSTN, PBX	
Transmission speed			seconds	
Modem speed: maximum			Kbps	
Resolution: standard			8x3.85 line/mm, 200x100 dpi	
Resolution: option			16x15.4 line/mm, 400x400 dpi	
Compression method			MH, MR, MMR, JBIG	
Scanning speed	81 spm	68 spm	81 spm	68 spm
Memory: standard			4 MB (320 pages)	
Memory: maximum			60 MB (4,800 pages)	
PAPER HANDLING				
Recommended paper size			Standard paper tray(s)SRA3, A3, A4, A5, A6, B4, B5, B6, Envelopes Optional paper tray(s)SRA3, A3, A4, A5, A6, B4, B5, B6, Envelopes Bypass traySRA3, A3, A4, A5, A6, B4, B5, B6, Envelopes, Custom Size paper (Width: mm x mm, Length: mm x mm)	
			Duplex tray	
Paper input: standard			1,200 sheets	
Paper input: maximum			4,700 sheets	
Paper output: standard			500 sheets	
Paper output: max.			1,625 sheets	
Paper weight			Trays (60 - 300 g/m ²), Bypass (52 - 300 g/m ²), Duplex (52 - 256 g/m ²)	
Paper types			Plain paper, Recycled paper, Special paper, Colour paper, Letterhead, Cardstock, Preprinted paper, Bond paper, Coated paper, Envelope, Gloss paper, Label paper, OHP	

RICOH IM C3000A/IM C3000/IM C3500A/IM C3500

MAIN SPECIFICATIONS

ECOLOGY	IM C3000A	IM C3000	IM C3500A	IM C3500
Power consumption: max.	< 1,700 W			
Power consumption operation: B&W	503.3 W	503.3 W	532.9 W	532.9 W
Power consumption operation: Full colour	559.7 W	559.7 W	598.6 W	598.6 W
Power consumption: ready	47.6 W			
Power consumption: sleep	0.55 W			
TEC*	0.34 kWh/week	0.34 kWh/week	0.39 kWh/week	0.39 kWh/week

* It is a reference value based on the ENERGY STAR Ver.3.0 test method.

INPUT/OUTPUT TRAYS AND FINISHER OPTIONS

1x 550-sheet paper tray	Paper size: (SRA3, A3, A4, A5, A6, B4, B5, B6), Paper weight: (60-300 g/m ²)
2x 550-sheet paper tray	Paper size: (SRA3, A3, A4, A5, A6, B4, B5, B6), Paper weight: (60-300 g/m ²)
2,000-sheet Large capacity tray	Paper size: (A4), Paper weight: (60-300 g/m ²)
1,500-sheet side Large capacity tray	Paper size: (A4, B5), Paper weight: (60-300 g/m ²)
1,000-sheet Hybrid finisher	Paper size: (SRA3, A3, A4, A5, A6, B4, B5, B6), Paper weight: (52-300 g/m ²), Staple capacity: (50 sheets), Staple paper size: (A3, A4, B4, B5), Staple paper weight: (52-105 g/m ²), Staple positions: (Top, Bottom, 2 Staples)
1,000-sheet Booklet finisher	Paper size: (SRA3, A3, A4, A5, A6, B4, B5, B6), Paper weight: (52-300 g/m ²), Stack capacity: (1,000 sheets), Staple capacity: (50 sheets), Staple paper size: (A3, A4, B4, B5), Staple paper weight: (52-105 g/m ²), Staple positions: (Top, Bottom, 2 staples, Booklet)
250-sheet Internal finisher	Paper size: (A3, A4, A5, A6, B4, B5), Paper weight: (52-300 g/m ²), Stack capacity: (250 sheets), Staple capacity: (5 sheets), Staple paper size: (A3, A4, B4, B5), Staple paper weight: (64-80 g/m ²), Staple positions: (Top)
500-sheet Internal finisher	Paper size: (A3, A4, A5, A6, B4, B5), Paper weight: (52-300 g/m ²), Stack capacity: (500 sheets), Staple capacity: (50 sheets), Staple paper size: (A3, A4, B4, B5), Staple paper weight: (52-105 g/m ²), Staple positions: (Top, Bottom, 2 staples)
Internal shift tray	Tray capacity: (250 sheets), Paper size: (SRA3, A3, A4, A5, A6, B4, B5, B6), Paper weight: (52-300 g/m ²)
One-bin tray	Tray capacity: (125 sheets), Paper size: (A3, A4, A5, B3, B4), Paper weight: (52-300 g/m ²)

OTHER OPTIONS

Fax unit, G3 Interface, Fax connection unit, Fax memory unit, Cabinet, Caster table, VM card, Memory unit, Side Tray, Banner paper guide tray, Punch units, Internal Multi-fold unit, Camera direct print card, PostScript 3, Bi-directional IEEE 1284, IEEE 802.11 a/g/n, Device server unit, File format converter, OCR unit, Enhanced security HDD, Data overwrite security unit, Small paper feeding unit, Page keeper, Imageable area extension unit, ADF handle, External keyboard bracket, Counter I/F unit, Key counter bracket, NFC card reader, Smart card reader built-in unit, EFI controller, EFI Impose, EFI Compose, EFI Hot folders, EFI Spot on

CONSUMABLES

Toner (black)	31,000 prints
Toner (cyan/magenta/yellow)	19,000 prints
Consumable yield based on 3p/j 5% coverage on A4	



RICOH @Remote

COMMISSION REGULATION (EU) 2019/2020. The light source of this product is not intended for applications other than image printing.

S.C. Heidelberger Druckmaschinen Romania S.R.L.

The Netherlands



RICOH
imagine. change.

All brand and/or product names are trademarks of their respective owners. Specifications and external appearance are subject to change without notice. The images in this brochure are not real photographs and slight differences in detail might appear, including in relation to colour. Not all services and solutions are available to all customers. Copyright © 2024 Ricoh Europe PLC. All rights reserved. This brochure, its contents and/or layout may not be modified and/or adapted, copied in part or in whole and/or incorporated into other works without the prior written permission of Ricoh Europe PLC.